



721 S ELM ST

DENTON, TX 76201

Kris Smith
O: 940.381.2220
kris.smith@svn.com



Property Summary

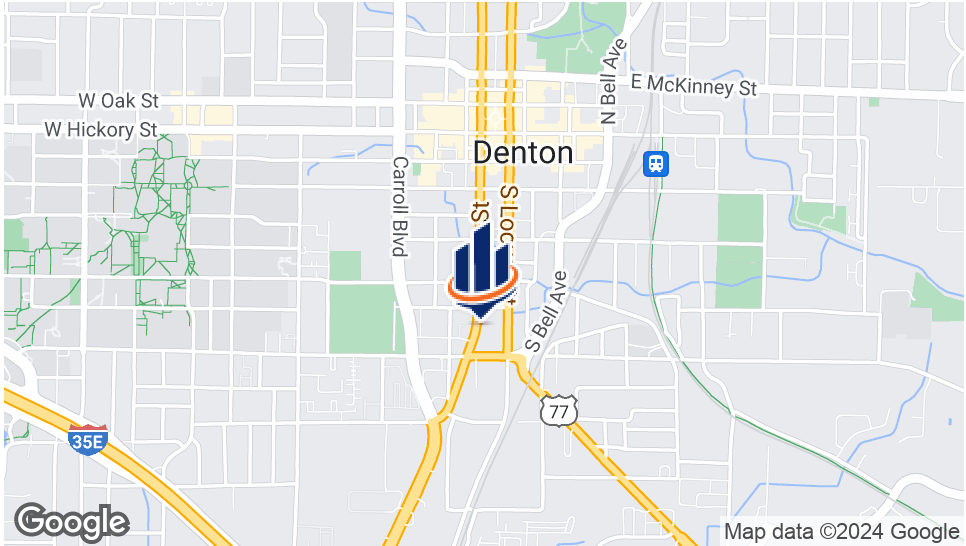

OFFERING SUMMARY

Lease Rate: \$15.00 - 18.00 SF/yr (NNN)
Building Size: 3,576 SF
Available SF: 2,752 SF

PROPERTY OVERVIEW

- Easy Access to Downtown Denton
- High Traffic Counts
- Ample Parking

The information presented here is deemed to be accurate, but it has not been independently verified. We make no guarantee, warranty or representation. It is your responsibility to independently confirm accuracy and completeness. All SVN® offices are independently owned and operated.

Lease Spaces

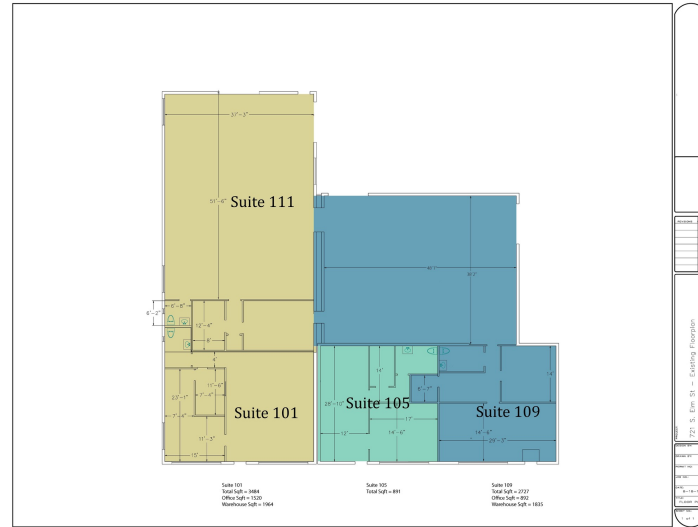

LEASE INFORMATION

Lease Type: NNN Lease Term: Negotiable
 Total Space: 2,752 SF Lease Rate: \$15.00 - \$18.00 SF/yr

AVAILABLE SPACES

SUITE	TENANT	SIZE [SF]	LEASE TYPE	LEASE RATE	DESCRIPTION
Suite 109	Available	2,752 SF	NNN	\$15.00 - 18.00 SF/yr	-

Floor Plan

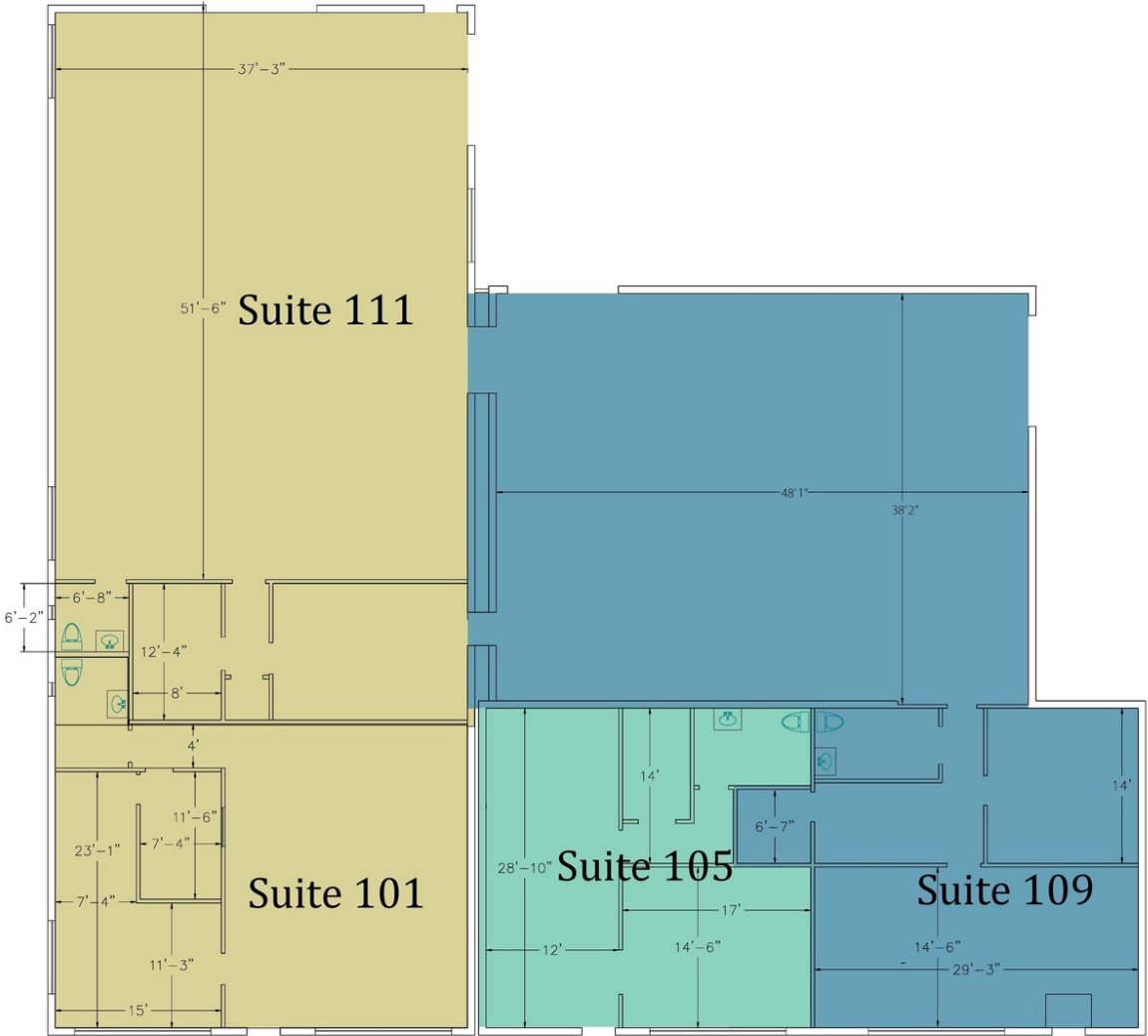

REVISIONS	DATE

PROJECT: 721 S. Elm St — Existing Floorplan

DESIGN BY:
DRAWN BY:
PERMIT NO.:

The information presented here is deemed to be accurate, but it has not been independently verified. We make no guarantee, warranty or representation. It is your responsibility to independently confirm accuracy and completeness. All SVN® offices are independently owned and operated.

Location Map

